

dCS



Lina 2.0

A major performance upgrade for the Lina Network DAC

dCS

Lina 2.0 brings a range of new features, including new Mapper settings, filter options, and balance controls, to the Lina Network DAC

At dCS, we are dedicated to enhancing the performance of our products throughout their lifespan.

Lina 2.0 is a major software upgrade that brings a range of new features – including new Mapper settings, filter options, and balance controls – to the Lina Network DAC.

The upgrade builds on our vision to create a versatile DAC that excels in a vast range of audio setups – including headphone and loudspeaker-based systems – and delivers all the benefits people have come to expect from dCS.

It is the result of extensive development, and is available free of charge to all Lina Network DAC owners.

dcsaudio.com

ONLY THE MUSIC

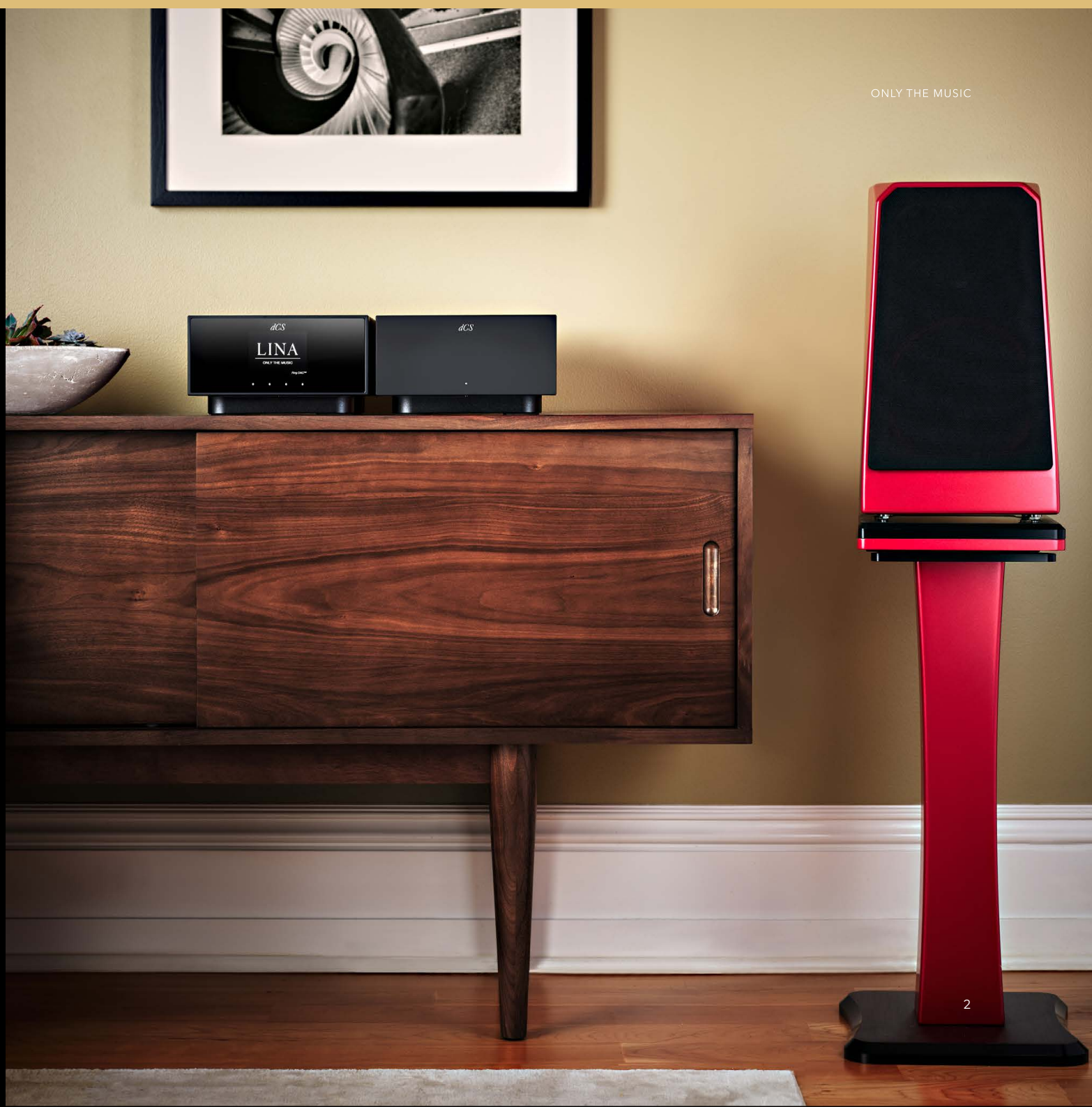

What's new?

Two new Mapper settings

Lina 2.0 brings two new Mapper settings to the Lina Network DAC. These settings – first introduced in the dCS Vivaldi, Rossini and Bartók ranges – enable the Ring DAC to operate at double speed [5.6 or 6.14MS/s].

These additional settings are the result of careful refinement and continuous development. Since releasing the original Mapper [now MAP 2], we have continued to refine our process and improve jitter performance. We are now able to offer the option of a higher ring rate – a development which, in turn, allows us to move matching noise further out of the audible band – along with other improvements and refinements to our mapping algorithm. Listeners can now choose from double-speed settings or the original dCS Mapper depending on their preference.

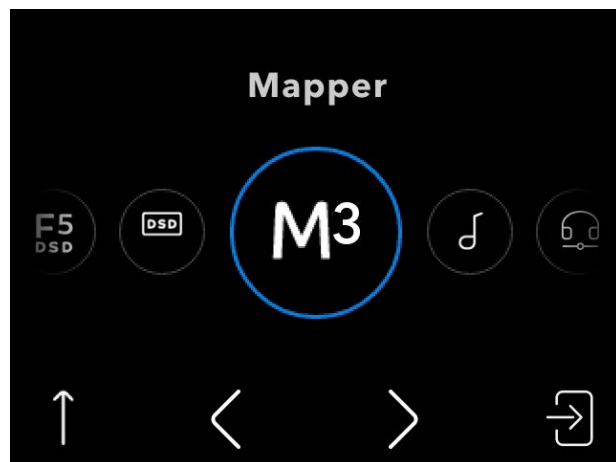

DSD128 Upsampling

A new DSD128 upsampling feature – as seen in the dCS Vivaldi, Rossini and Bartók DACs and Players – allows the Lina Network DAC to convert PCM audio to DSD at a greater speed, pushing noise higher in the frequency range [to somewhere above 40kHz]. This, in turn, allows the use of gentler filters. Depending on a listener's music choice, this can result in improved spatial presentation, and a more natural, nuanced sound.

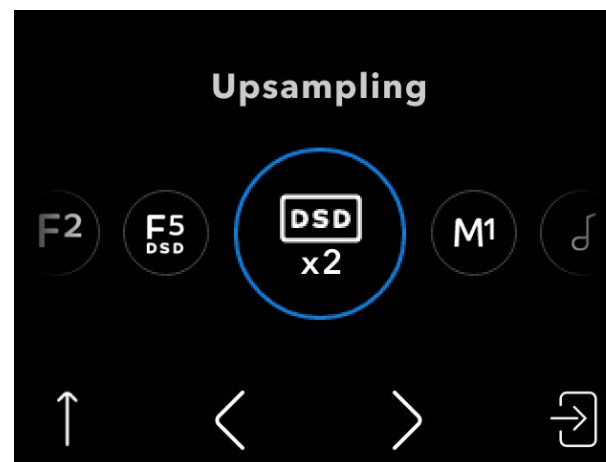

Text Size Settings for Distance Listening

A user interface update offers the option to increase text size on the Lina Network DAC's LED display, making it easier to read track titles when listening to the product from a distance.

Small

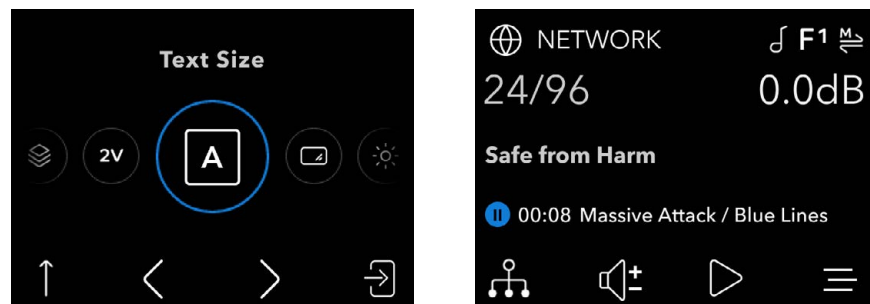

Large

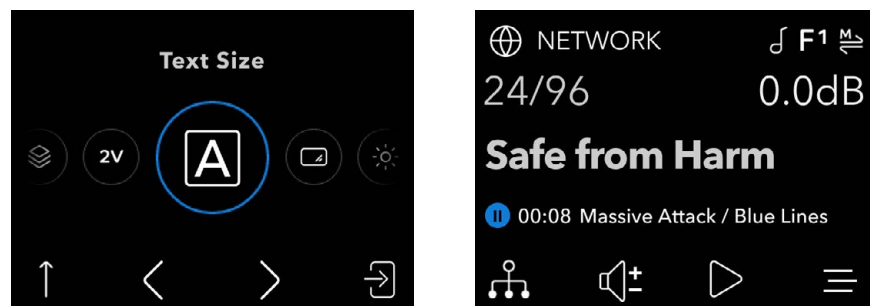

New PCM and DSD Filters

All dCS DACs provide a range of carefully designed filter options, allowing listeners to select the setting that best suits their music and their individual preferences.

The Lina Network DAC launched in 2022 with a choice of two filters, F1 and F2, for ease of use. The 2.0 update brings four new PCM filters, plus an additional DSD filter [F5] with a relaxed roll-off and smoother phase response.

This brings the number of filters available with the Lina Network DAC in line with our Rossini and Bartók DACs, and gives listeners even more control over their system's performance.

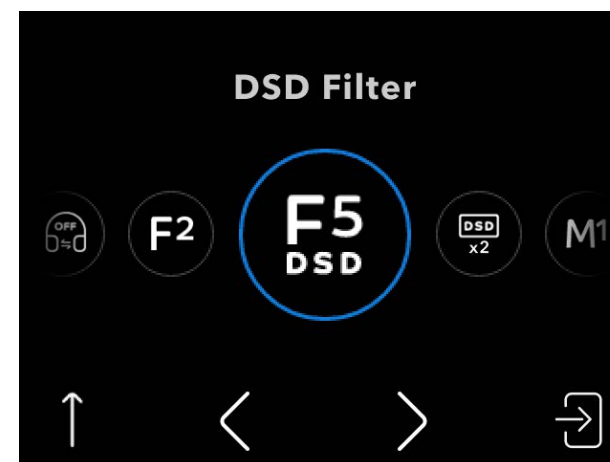

Balance Controls

An additional balance control function – also available with the Bartók APEX – allows listeners to adjust left and right balance when listening with headphones or loudspeakers.

This means Lina Network DAC owners can now adjust the volume of each channel in isolation, and compensate for volume differences between left and right channels – whether due to system challenges such as non-ideal speaker placement, or auditory imbalances – for a more natural presentation of sound.

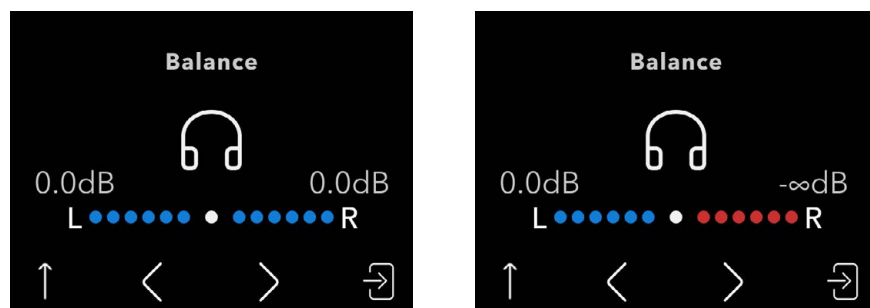

Remote Control Support

It is now possible to control the Lina Network DAC with a dCS remote control or generic remote. See the Lina Network DAC 2.0 release notes for further details.

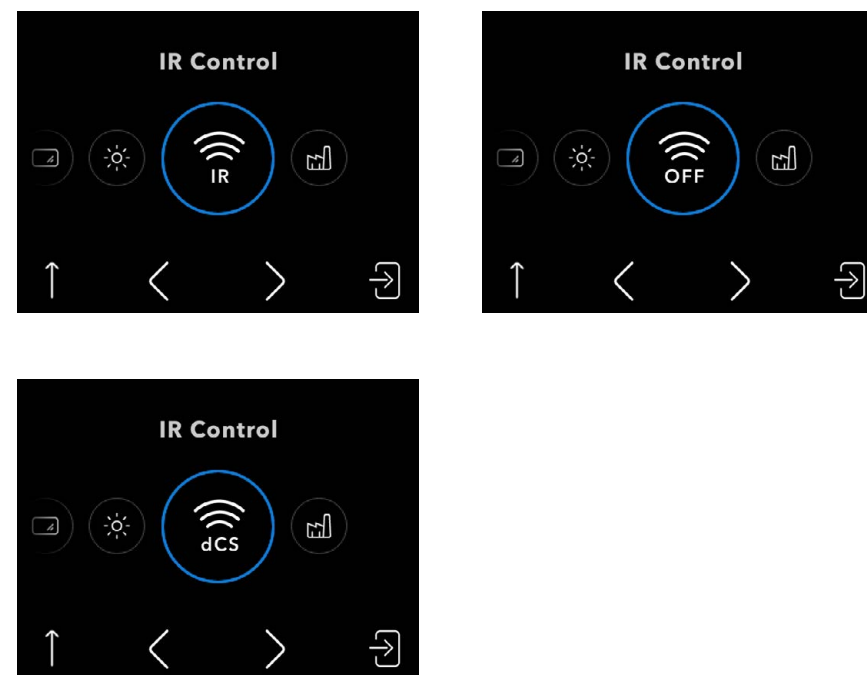

Download & Support

Lina Network DAC 2.0 is available to download now through the dCS Mosaic app from October 17.

The dCS Mosaic app has been updated to provide support for Lina Network DAC 2.0, along with new features available for all dCS devices with network streaming capabilities. Download our Mosaic v1.42 release notes to find out more.

Find out more about the Lina Network DAC [here](#).

Use our [Dealer Locator](#) tool to find a Lina retailer near you.

